

MEDIA TABLES

THE WORKPLACE CONTINUES TO EVOLVE, BUT THE NEED FOR THOUGHTFUL HYBRID INTERACTIONS PERSISTS. WE DESIGNED THE MEDIA TABLES TO SOLVE A COMMON PROBLEM, CREATING NATURAL SIGHT LINES FOR DIGITAL INTERACTION.

THE ASYMMETRIC TAPER ALLOWS FOR AN EQUITABLE EXPERIENCE AROUND THE TABLE WITHOUT AWKWARD LEANING IN OR OUT.





**IN OPEN OFFICE SETTINGS,
THESE FUN AND
LIGHTWEIGHT TABLES
CAN MIGRATE EASILY TO
WHEREVER THE MEETING
IS. BRING THE CONFERENCE
ROOM TO YOU.**

DYNAMIC SHAPE AND SIZING
OPTIONS ALLOW THESE
TABLES TO WORK IN SPACES
WHERE OTHER LARGE TABLE
MAY NOT FIT INCLUDING
NOOKS OR SMALLER
CONFERENCE ROOMS.

MOMENT Media Tables



- Options / Notes:**
- Casters:** +\$90 (hieght not altered)
 - Custom Power Cutouts:** +\$150
 - Table Hieght:** 29.5" / 36" / 42"+\$200
 - *Footbar Type B:** 42" tall table ONLY
 - TFL Edge:** edgeband ONLY
 - HPL Edge:** edgeband / MDF 90 / MDF Knife / MDF trim
 - PLY Edge:** PLY 90 / PLY knife
 - Bag hooks standard on all tables**

Dimensions			Surface Material			Footbars		Cable Cover
D	W	MODEL NUMBER	TFL	HPL/ Mirlux	PLY	TYPE A	TYPE B*	PLY
48"	72"	MTMD4872	2490	3300	3790	+650	+400	+170
48"	84"	MTMD4884	2680	3580	4050	+740	+430	+185
48"	96"	MTMD4896	2760	3760	4400	+830	+460	+200

MOMENT Table Accessories

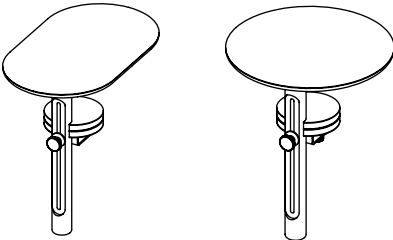
	D	W	H	MODEL NUMBER	Price
Pivot Tables 	Racetrack				
	12"	20"	20"	MTAPTO	600
	Round				
	16"	16"	20"	MTAPTR	600

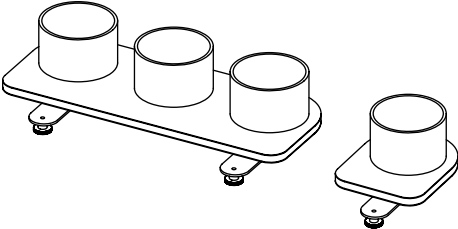
Planters 	Single				
	12"	9"	9"	MTAPL1	250
	Tripple				
	12"	24"	9"	MTAPL3	400

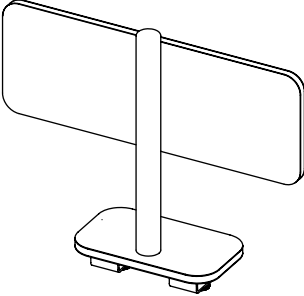
TV Mount 	8"	28"	24"	MTATV	700
--	----	-----	-----	--------------	-----

Pivot Table / Planters / TV Mount can clamp onto any surface less than 1.25" thick

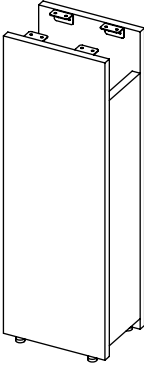
Cable Tower 	Plywood				
	7"	10"	28"	MTACT28	500
	7"	10"	34.5"	MTACT34	600
	7"	10"	40.5"	MTACT40	700
	TFL				
	7"	10"	28"	MTACT28	330
	7"	10"	34.5"	MTACT34	380
	7"	10"	40.5"	MTACT40	420

All tables come with 5 under surface cable clips and 3 cable straps for table legs

The heights of the Cable Tower correspond to 29.5" / 36" / 42" table hieghts

The Cable Tower can be mounted anywhere under the table surface

MOMENT Table Cable Management

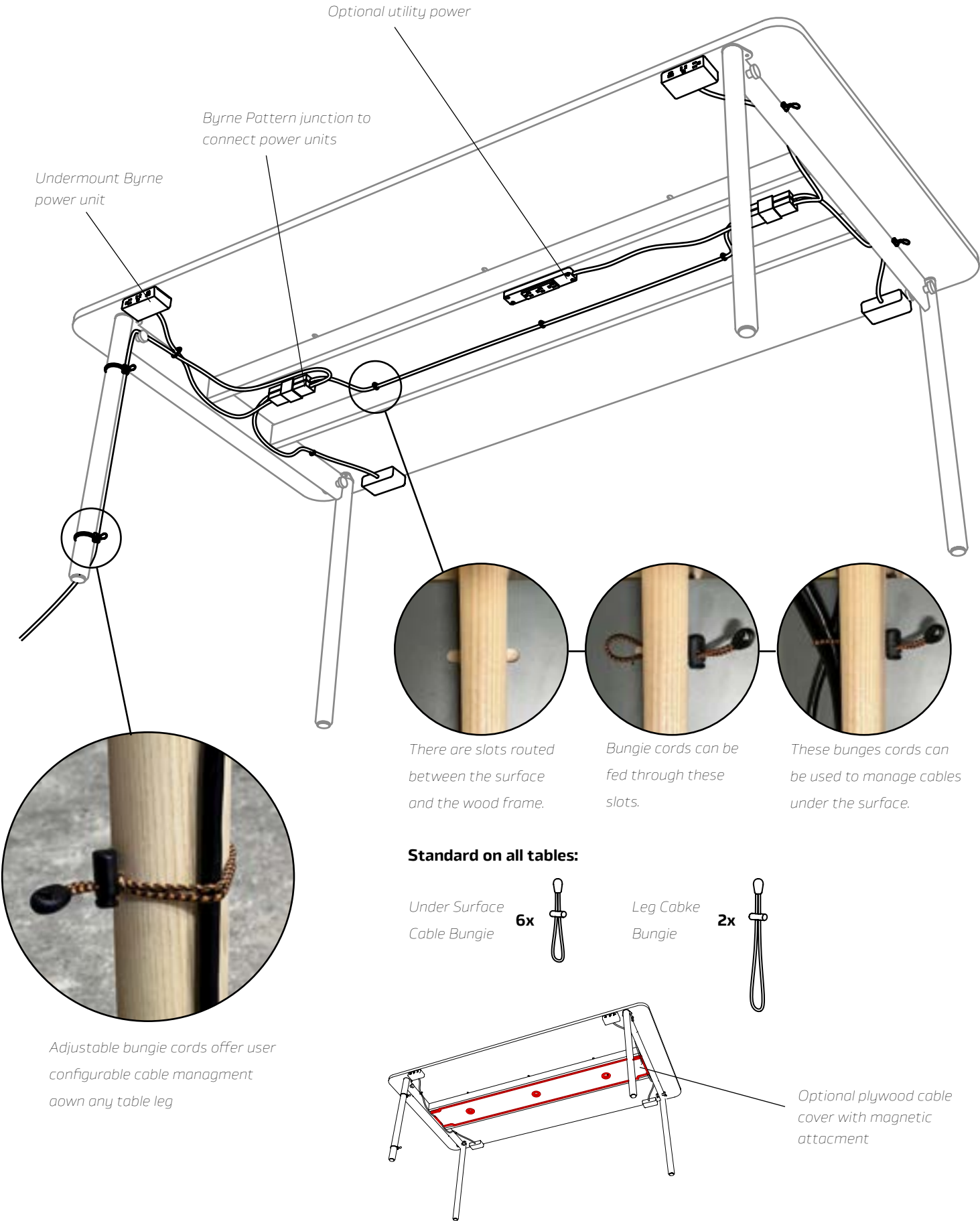

MOMENT Table Power Placement

Social Tables	Meeting/Perch Tables	Community Tables
---------------	----------------------	------------------

Under Surface Perimeter Power

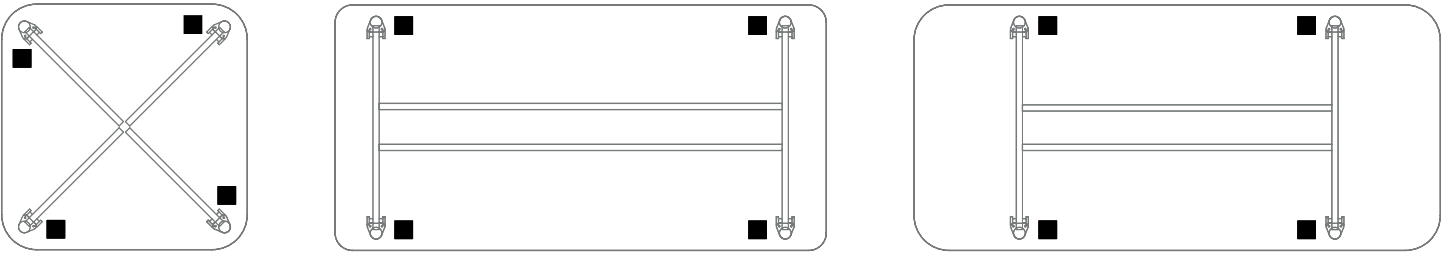

All power units are 2" back from the edge of the surface and 2" in from the interior of the table legs

Single In-Surface Power

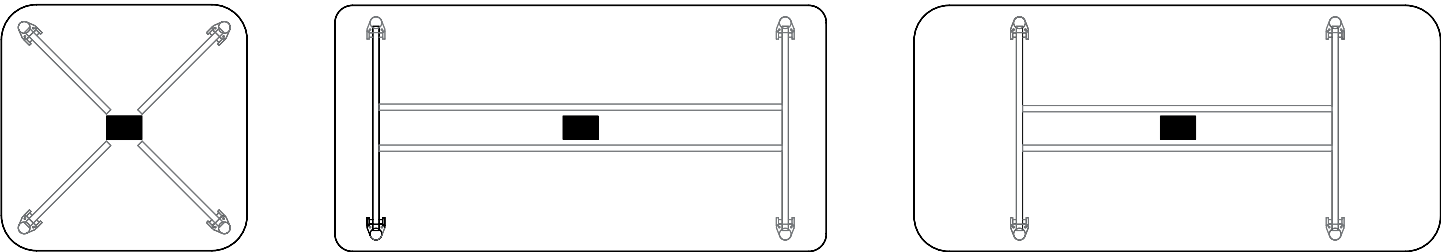

Double In-Surface Power

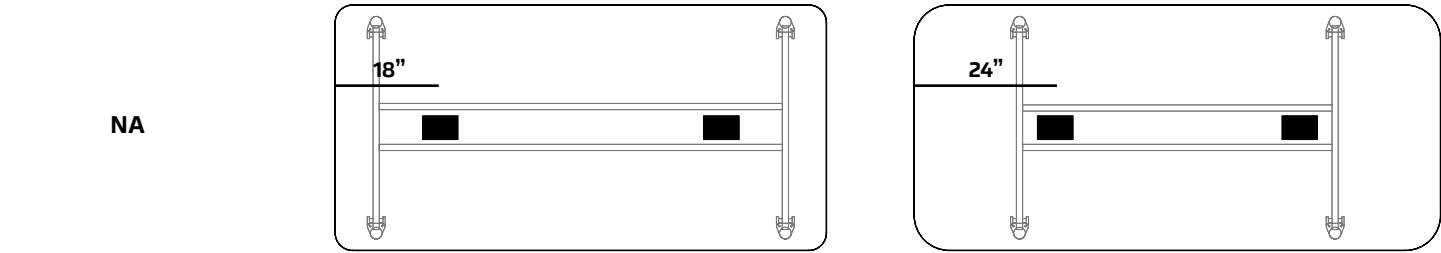

NA

Grommet Locations

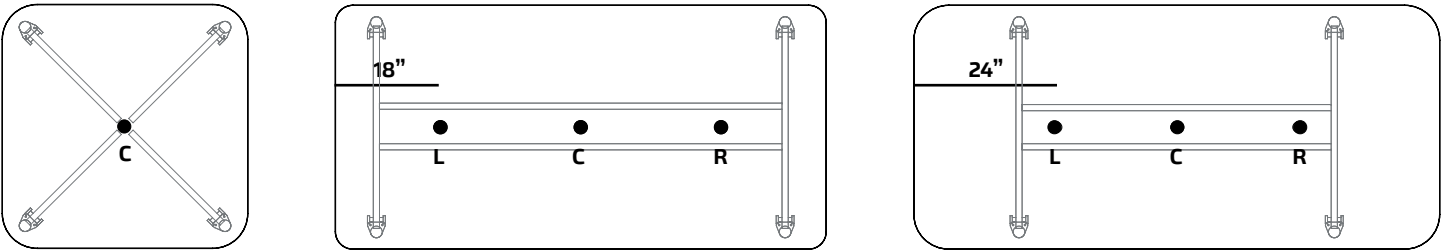

If a grommet is specified in the same location as a power unit it will be pushed 2" interior of the power unit or 2" to the right depending on the configuration. **+\$55 list per grommet**

MOMENT Table Power Offering

Notes:

All multi-unit configurations (perimeter power / inline utility power / or double in-surface power) are accomplished using Byrne Electric's Pattern system or our Built in USB C charging system. This mean all individual power units or ports are chained together and a single cord (infeed) powers the whole system.

Options:

Braided Infeed Cord: +\$100

Hardwired Infeed: +\$200

Finish option on Byrne website.
Select finishes may add extra cost.

Power Unit	Description	Perimeter*	Single In-Surface	Double In-Surface**
------------	-------------	------------	-------------------	---------------------

Built in 100 Watt USB C

4 port: 1 port per leg

1950

NA

NA



This power solution is proprietary to Makr Furniture and the Moment Tables & Desks. It integrates a 100-Watt USB C charging port into each table leg. This is enough power to charge devices ranging from cell phones to full sized laptops. In addition to power, hardware data, peripherals, and displays can pass through these ports with the use of data Hubs. Makr can work with your technology needs to help specify the proper Hub for your application. A data hub is not included in this price.

Finch



3 port: 2 PWR / USB A + C

2660

NA

NA

Dean



3 port: 3 PWR

2130

375

1010

3 port: 2 PWR / 1 USB A + C

2750

500

1275

Ellora B



4 port: 2 PWR / Dual USB A / 1 Open

NA

625

1940

4 port: 3 PWR / USB A + C

NA

625

1940

Pepper



1 port: 1 PWR

NA

125

725

HQ2



4 port: 1 PWR / Dual USB A / 2 Qi

NA

830

2440

Utility Power***

3 port: 3 PWR

250

250

NA



inline



stand alone

*Perimeter power comes with 4 power units chained together into one system with a single power infeed

**Double in-surface power comes with 2 power units chained together into one system with a single power infeed

***Utility power is mounted under the surface and will be connected in line with the other power units by default. If you want a stand alone utility power unit with its own power cord it will be a 2 port byrne MiniTap and will cost \$115 list.

PERCH TABLES

Rectangular



Racetrack



D: 24"-30" W: 48"-96" H: 29.5", 36", 42"

SESSION
TABLES

Rectangular



Racetrack



D: 30"-48" W: 48"-96" H: 29.5", 36", 42"

MEDIA TABLES



D: 48" W: 72"-96" H: 29.5", 36", 42"

COMMON TABLES

Round



Square



D/W: 42"-60" H: 29.5", 36", 42"

COMMUNITY TABLES

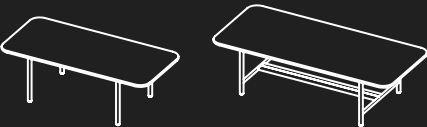

D: 36"-60" W: 84"-120" H: 29.5"

ACCESSORIES



Cable
Tower Media
Stand



Planters Pivot
Tables



MAKR FURNITURE
8805 S 190TH ST, KENT,
WA 98031
MAKR-FURNITURE.COM